

Location: _____



P6560-THTD

**12" Wide, Stainless Steel
Threshold Drain**

Specification: MIFAB® Series P6560-THTD Threshold Trench Drain, 12" wide, 11 gauge fabricated Type 304 stainless steel channels (conforming to ASTM A-240) and Load Class "B" stainless steel non-slip Wedgewire grates per DIN EN 1433 with vandal proof lockdowns and bead blasted finish. Grates meet ADA and heel-proof requirements. Channels available in either 36", 48", 60", 72", 96" or 108" lengths. Center outlets are standard in 4" no hub connections and fabricated as part of the trench drain system. 6" no hub outlet is available as an option.

Function: Used in Fire Service Access Elevators. Prevents water used to extinguish fires from entering the elevator shaft, protecting emergency personnel with egress and staging requirements. Installed in front of elevator door or elevator bank.

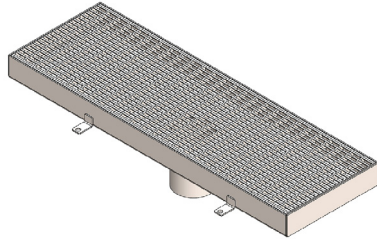

Illustrated with Wedgewire grate



SCAN ME

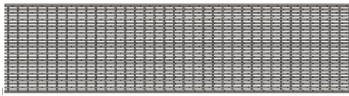
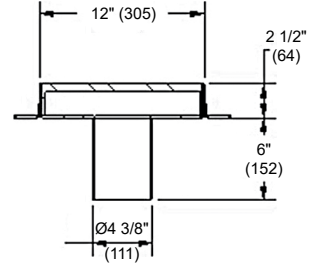

Wedgewire grate (Standard)

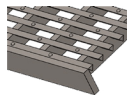

Wedgewire grate
cross section view

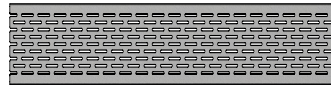

-FS - Fabricated slotted grate

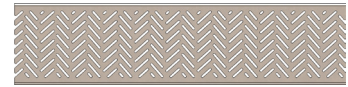

-AS - Fabricated angle slotted grate

Note: The neoprene gasket used to connect long runs of trench drain channels is not recommended for use with caustic or harsh chemicals. In these cases, it is recommended that the trench drain channels be welded on site.

MODEL NUMBER	DESCRIPTION	GRATE FREE AREA (Sq. In.)	WEIGHT Lbs.
P6560-THTD-36	12" wide, 36" long Wedgewire grate	250	36
P6560-THTD-48	12" wide, 48" long Wedgewire grate	335	46
P6560-THTD-60	12" wide, 60" long Wedgewire grate	419	57
P6560-THTD-72	12" wide, 72" long Wedgewire grate	503	72
P6560-THTD-96	12" wide, 96" long Wedgewire grate	672	93
P6560-THTD-108	12" wide, 108" long Wedgewire grate	756	104

NOTE: Other widths are available. Contact MIFAB® for details

SUFFIX	OPTIONAL VARIATIONS
-6NH	6" No hub outlet connection
-7	1/2" Trap Seal Primer connection
-7MG	MI-GARD Trap Seal Protection device (4" or 6")
-29	Type 316 Stainless Steel
-FLC	Anchor (waterproofing) flange and membrane clamp
-PC	Powder coated, (one color choice)
-PC2	Powder coated, (two tone color choice)

SUFFIX	OPTIONAL GRATES
-AS	Fabricated, Type 304 Stainless Steel angle slotted, heel-proof and ADA compliant grate, Load Class A
-FS	Fabricated, Type 304 Stainless Steel slotted, heel-proof and ADA compliant grate, Load Class A

CALIFORNIA PROPOSITION 65 WARNING. This product contains chemicals known to the State of California to cause cancer and birth defects or other reproductive harm.

Job Name: _____ Page No: _____
 Section No: _____ Contractor: _____
 Schedule No: _____ Purchase Order No: _____

MIFAB® reserves the right to make changes in material and design without formal notice or obligation. USA: 1-800-465-2736 www.mifab.com CAN: 1-800-387-3880